



OPTIMIZE THE PICK

With Compact Store Flow and picking tools

COMPACT TWIN

COMPACT VERTICAL LIFT



Do you have a workshop store from which you pick parts for your production lines? Do you pick orders for fitters at a building site? Or do you pick and pack various items from a central e-commerce warehouse? No matter the type of warehouse, we can always help you streamline your warehouse management processes, reducing errors and increasing profitability.





Raise warehouse picking to a completely new level

By replacing traditional warehouse shelves with one or more of our vertical storage lifts, you do not only get a more vertically streamlined warehouse that saves up to 90 % of the available floor space. Employees also avoid having to run between warehouse shelves and amongst trucks. Instead, items are delivered on a load tray at the handling opening at the correct picking height. Much more ergonomic, time-saving, and easy to manage. Used in combination with our Compact Store Flow software and picking tools, we can guarantee that your warehouse efficiency will be raised to a completely new level.

Easy to install

Save time during installation

Full control of your warehouse

Compact vertical storage lifts come in a variety of models and sizes. Sometimes you need one, sometimes several. Or you can start with one and add more later without disrupting production. Products that are stored inside the vertical storage lift are assigned space based on various parameters, e.g. how often they are picked or what items are usually picked at the same time. Our Compact Store software helps you keep track of product balances, where items are stored, and on which load tray they can be found.

Pick from the lift

As soon as an order comes into your company and is added to the business system (ERP), Compact Store receives the same information at the vertical storage lift. The operator can then start the order immediately and begin picking. Compact Store then delivers one or more load trays containing the correct items to the handling opening. The operator can pick items from the load tray, calmly and methodically, at a comfortable working height. Each item picked is acknowledged

using a scanner, foot pedal, or button push before being placed or packed on a work table, truck, or rack located next to the vertical storage lift, and is then delivered externally or moved on internally within the company.

Compact Store automatically keeps a check on stock balances as they change when an item is acknowledged.



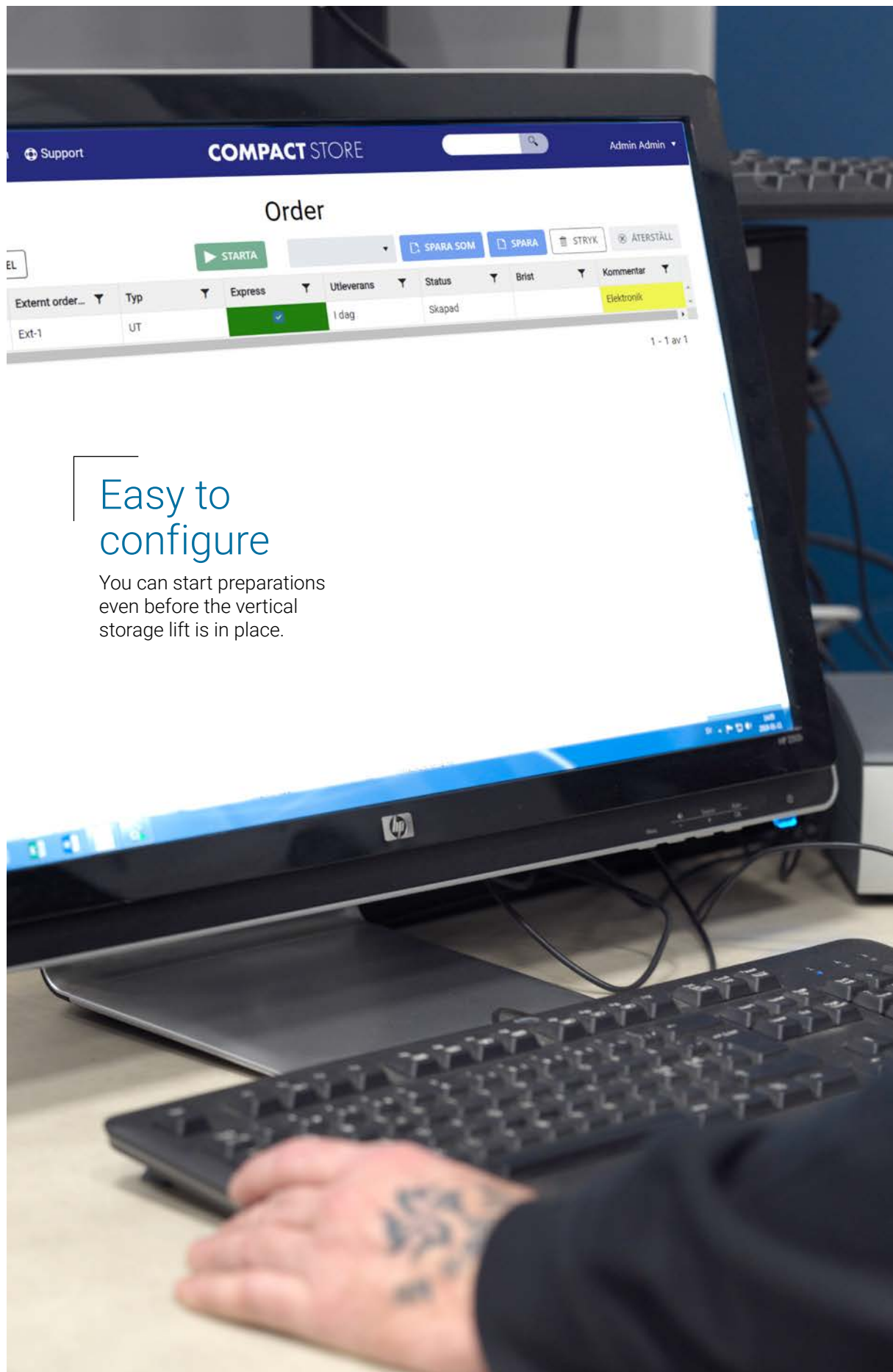

For more information about the various different levels and the best way to work in them, visit welandolutions.com. You will also be able to access a number of documents, including System Setup, Installation Description, and User Guide, as well as a selection of training materials.

COMPACT STORE

The software that controls the system

In order to streamline picking using one of our picking solutions, the vertical storage lift must be controlled by Compact Store software. Compact Store is our own scalable control system that is suitable for use both by small businesses that want to maintain complete control over their product balances and workflows, and the operators of large warehouses who want to pick and pack orders in the fastest and most efficient manner. Of course, Compact Store is able to communicate with your business system, no matter which one you use. There are several different levels of Compact Store. The system can be expanded as you make changes or grow your business.

Stand Alone

Stand Alone is suitable for businesses that do not have a particularly intensive picking operation but want a stock room/warehouse that is kept neat and tidy. All items are stored protected from dirt and unauthorised access inside the vertical storage lift. In this version, Compact Store is operated manually on a local computer without connect to a business system. The operator manually creates put in and pick lists - if barcodes are available, these can easily be utilised using a scanner.

Basic Solutions

Basic Solutions is the version to go for if you need a more intensive picking speed, with greater efficiency and more controlled picking. Compared with traditional stock/warehouse management tools, you can easily increase pick efficiency by over 150%. Compact Store Basic Solutions is connected directly to your business system (ERP), meaning that orders can be sent directly between the systems. Put-aways and take-outs, as well as stock control are easily managed using the order overview. A label printer ensures that all items are marked with the correct information. To ensure a high level of picking accuracy, it is normal to acknowledge pull-outs using a scanner.

Picking Solutions

Picking Solutions is the system to use where output is subject to stringent demands in instances where you want to be able to start multiple orders at the same time. The algorithms in Compact Store analyse order lines and calculate the most efficient co-pick from each load tray. To ensure that the right item is picked from the load tray, we offer a number of picking tools, e.g. pick display, light pointer, or LED bar, all tailored to your needs. By adding Put-to-Light or Put-to-Screen at pick-to-station, we can maximise your picking speed and minimise the risk of picking errors.

Custom Solutions

Custom Solutions is a bespoke solution where we work together to tailor the system solution based on your unique warehouse operation. Custom Solutions can encompass the entire warehouse and also manage picking stations such as shelf stations and pallet stations outside lifts. In such instances, an iPad or tablet computer with a simplified menu system is used to control which picks or input deliveries are made.

Compact Store system functions

COMPACT STORE

	STAND ALONE	BASIC SOLUTIONS	PICKING SOLUTIONS	CUSTOM SOLUTIONS
Communication with one or more Compact Lift/ Twin/ Double	✓	✓	✓	✓
Manage different users and access rights	✓	✓	✓	✓
Create and maintain manual orders	✓	✓	✓	✓
Create order as an order template	✓	✓	✓	✓
Manual storage, removal, and inventory	✓	✓	✓	✓
Create inventory assignments and ongoing stock control	✓	✓	✓	✓
Express order	✓	✓	✓	✓
Choice of floating or fixed places	✓	✓	✓	✓
Manage item register	✓	✓	✓	✓
Automatic place selection	✓	✓	✓	✓
Manage storage sizes in vertical storage lifts	✓	✓	✓	✓
Connect items to storage sizes	✓	✓	✓	✓
Run pick display, LED strip, light pointer	✓	✓	✓	✓
Manage tray layout	✓	✓	✓	✓
Control of item against permitted storage location/max quantity	✓	✓	✓	✓
Item data import	✓	✓	✓	✓
Use scanner for item search	✓	✓	✓	✓
Retrieve tray information from lift	✓	✓	✓	✓
Show lift status	✓	✓	✓	✓
Manage file import and export of files between ERP and Compact Store		✓	✓	✓
Split several vertical storage lifts across different picking zones		✓	✓	✓
Lock item		✓	✓	✓
Alternative stock control range depending on storage location		✓	✓	✓
Discrepancy list		✓	✓	✓
Acknowledge with scanner		✓	✓	✓
Print out of labels containing information, EAN code, and QR code		✓	✓	✓
Co-pick of orders, i.e. Many orderpicks from same loadtray		✓	✓	✓
Multi-pick, i.e. Start several orders at the same time			✓	✓
Compact Similarity in order to maximise the number of pick hits on the load tray			✓	✓
Manage Put-to-Screen (additional hardware required)			✓	✓
Manage Put-to-Light (additional hardware required)			✓	✓
Scanner acknowledgement of parcel and pick locations and pick-to locations			✓	✓
Enables control of external storage locations				✓
Storage locations outside lift				✓
Division of warehouse into units/zones				✓
Manage high frequency goods in lift zone				✓
Management of item to maximum quantity per permitted zone				✓
Temporary storage locations				✓
Buffer locations				✓
Storage location groups such as pallet racks, shelf racks, and layout areas				✓
Replenishment points for vertical storage lift from other storage				✓
Storage location checklist				✓
Lock storage locations				✓

OPTION

Card or tag for logging into T50 and Compact Store Additional hardware and software required	✓	✓	✓	✓
---	---	---	---	---



Easy to grow
in the system

How efficient do you want to be?

COMPACT STORE

Easy to get started and easy to use

The menu structure in Compact Store is the same in all dialog boxes, which simplifies things for the operator. The user friendly interface means that settings can be quickly configured. You can easily create users, licenses, scanner system logs, design custom picking labels, etc. according to your requirements. Compact Store has grouped its various functions under the following icons: →

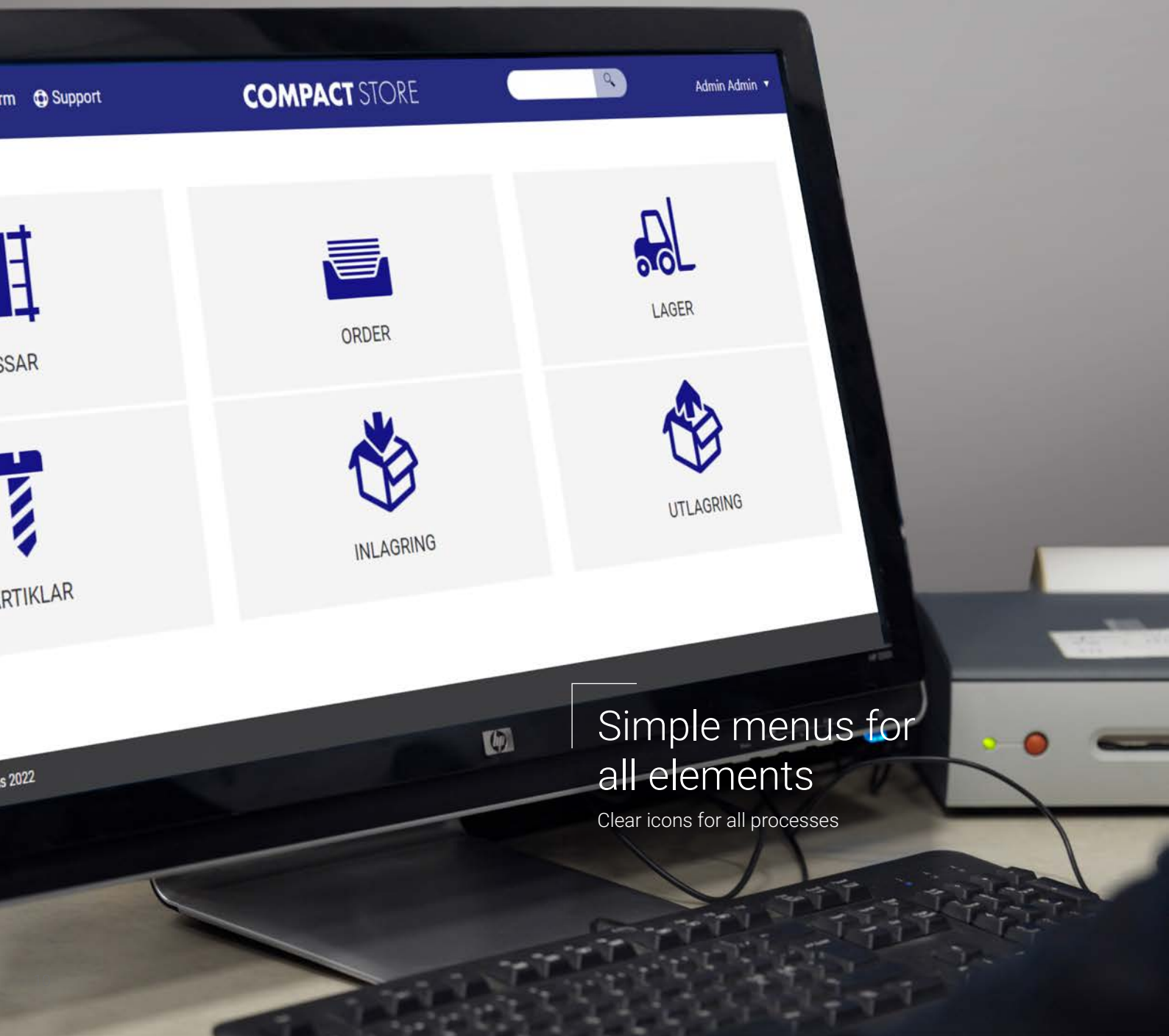

Simple menus for
all elements

Clear icons for all processes



CREATE LIFT ENVIRONMENT

Functions that set up the vertical storage lift and load trays that will receive stock products.
From here, you can do the following:

- Prepare content virtually before the vertical storage lift is in place
- Create and fit out load trays
- Create and copy tray storage locations
- Combine vertical storage lifts and split the warehouse into several different zones
- Equip the vertical storage lift with picking tools
- Check status – current tasks and storage locations
- Stock control vertical storage lift
- Request load tray
- Manage vertical storage lift maintenance



SET UP WAREHOUSE

Functions concerning storage space on the tray and the products it contains.
The more thorough the preparation work, the faster the transition.
From here, you can do the following:

- Prepare the warehouse virtually before the vertical storage lift is in place
- Build vertical storage lift storage locations and item locations
- Furnish load trays based on size and quantity of each product
- Select type of storage location – batch, fixed, or floating
- Determine the location of items in different zones based on size and pick frequency
- Create an overview of all storage locations in the system
- Reposition products
- Lock storage location



PROCESS ORDERS

Order-related functions. Create custom templates to strengthen your brand.
From here, you can do the following:

- Manage daily order processing
- Prioritise orders
- Show/start/cancel orders
- Make put-aways via the ERP system
- Easily import item files via drag and drop
- Manually add put-aways and take-outs
- Produce order history



MANAGE ITEMS

Functions that concern the management of items that are inside the vertical storage lift.
From here, you can do the following:

- Create/condition items – size, weight, pack size
- Import items – from business system/Excel file
- Create item descriptions
- Put-away
- Take-out
- Show/search item
- Change, delete, lock item
- Inventory item



PUT-AWAY/TAKE-OUT

Manual put-aways and take-outs

Simpler, faster, and fewer errors using the right picking solution

It isn't enough simply being able to pick items quickly from a vertical storage lift. You also need to create criteria for the operator to quickly find the right packing box to pick the items to so that they can move forward in the process. We have two Pick-To solutions to choose from: Put to Light and Put to Screen. Both solutions enable one person to carry out a very large number of picks per hour without any problem at all. Which of our pick-to solutions best meets your needs is dependent on the type of products and stock management systems you have.



COMPACT STORE PutToScreen

AKTUELLT PLOCK

PLATS NR: 46

ORDER: 4024071

ARTIKEL: A9F07106

FRÅN: H30511220000

ANTAL: 2

VISA KÖ	EJ VALDA RADER	VALDA RADER
ENHET		
H1	2	5
H2	0	3
H3	3	4



Put to Screen

A picking solution for varied orders from a large range of sku's

Put to Screen is a dynamic solution for multi-picks that involve a large number of different items. The operator themselves can choose how many orders are to be started at the same time. This means that if five different orders are to contain the same item, it is possible to pick them at the same time when the load tray is released in the handling opening. A display behind the packing boxes shows in which box the item has to be placed, the order to which it belongs, and what quantity. The system keeps track of everything, which means that the operator can work at a high tempo and with confidence, without having to worry about making a picking error.

1.

ORDER STARTED

Operator starts a number of orders between 1-172 pieces. This is managed in Compact Store. The system shows the order number, item number, quantity, and the location from which the item is to be picked.



3.

LABEL PLACED DURING PUT TO SCREEN

The label is attached directly on the box in the case of hazardous goods, or on the packing box for onward consolidation with other items.



2.

ACKNOWLEDGEMENT LABEL PRINTED

The label contains order information and an EAN or QR code.



- > A completely dynamic system
- > Multiple orders can be started simultaneously
- > Acknowledgement using scanner for highest level of accuracy
- > Fast output of order lines
- > Adapted for businesses that offer a wide variety of goods
- > A flexible picking system

5.

ITEM PLACED IN PACKING BOX

Put to Screen provides information about quantity and in which box the item is to be placed. Each order line is acknowledged using a scanner.



4.

ITEM PICKED FROM VERTICAL STORAGE LIFT

The quantity of the ordered item is shown on the pick display and taken from its storage location on the load tray that has arrived at the handling opening. The pick is acknowledged using a scanner or foot pedal.



6.

ITEM MOVED TO CONSOLIDATION/DELIVERY

The order is complete.



Put to Light

Picking solution for many of the same item for different orders

An efficient and quick solution for multi-picking when the operator has to pick an item that is included in multiple customer orders. Put to Light shows with which customer the item is to be placed after being picked from the vertical storage lift. A flashing light indicates the correct box and the LED bar indicates the quantity. Placed items are acknowledged by pressing a button on the display.

1.

ORDER STARTED

Operator starts a number of orders in Compact Store. This may vary between 1-172 orders depending on how many Put to Light stations are available.

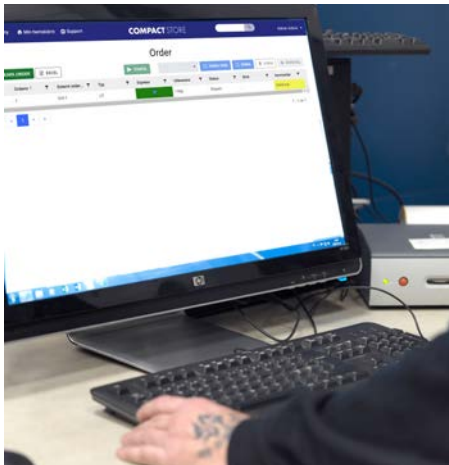

3.

LABEL PLACED DURING PUT TO LIGHT

The label is attached directly on the box in the case of hazardous goods, or on the packing box for onward consolidation with other items. Boxes are placed next to Put to Light.



2.

ACKNOWLEDGEMENT LABEL PRINTED

The label contains order information and an EAN or QR code.

- > A more static system for use where the same types of item and order are common
- > Multiple orders can be started simultaneously
- > Easy acknowledgement at the touch of a button
- > Fast output of order lines

5.

ITEM PLACED IN PACKING BOX BY PUT TO LIGHT

Put to Light provides information about quantity and in which box the item is to be placed. Each order line is acknowledged by pushing a button.



4.

ITEM PICKED FROM VERTICAL STORAGE LIFT

The quantity of the ordered item is shown on the pick display and taken from its storage location on the load tray that has arrived at the handling opening. The pick is acknowledged using a scanner or foot pedal.



6.

ITEM MOVED TO CONSOLIDATION/DELIVERY

The order is complete.





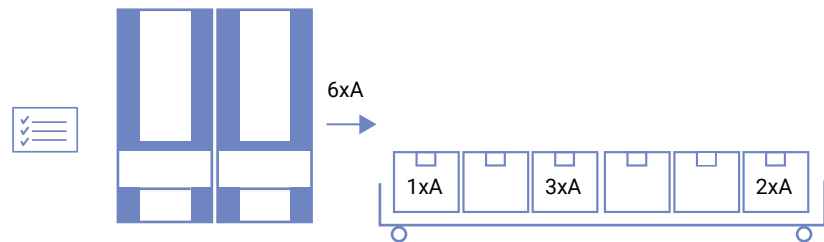

Example: 6 x item A are to be picked from the vertical storage lifts. These must then be allocated to three different customer orders, in accordance with the following: 1, 3, and 2 pcs. When the operator takes the items from the vertical storage lift and turns to the picking solution, they can clearly see in which packing boxes (orders) and in what quantity the items are to be divided. Acknowledgement using a scanner or push button to minimise the risk of picking errors.

Multi-pick

Even more efficient

Compact Store creates opportunities to increase picking efficiency even further by use of multi-pick. The system allows to calculate how you can best store items inside the vertical storage lift so that Compact Store can sort orders into groups and deliver them in the handling opening on the same load tray. This means that the operator can start and pick several orders simultaneously with a very high level of efficiency. Whilst picking is in progress, the system prepares the next group of items to be sent to be sent to the handling opening as soon as the previous group has been confirmed with a button push initiated by the operator. The operator avoids having to wait for the vertical storage lift for an unnecessarily long period of time and determines the speed at which picking takes place.

Picking tools make everything simpler, faster, and produce fewer errors

In order to enable operators to quickly identify where on the load tray an item to be picked is located, we offer a number of different picking tools. A pick display, light pointer, or LED bar help when a load tray containing items appears in the handling opening. Which of the is best suited for your application depends on the warehouse management method you use and the size of the products store in the vertical storage lift.

Pick display

The operator receives order information and an easy-to-understand image of the load tray on a clear, easy to read display. Colour coding indicates the position of the item in the relevant compartment from where it is to be picked. An arrow on the monitor indicates incoming or outgoing deliveries, enabling the operator to work without running the risk of making a picking error. The pick display is the most commonly used picking tool with vertical storage lifts, and may be sufficient on its own in instances where load trays are split into larger compartments. It can also be combined with other picking tools to facilitate the work still further or when the compartments are smaller and more numerous.

LED bar

LEDs that are placed in a row on the front edge of the lift opening. The diodes light by the line from which the item is to be picked and a digit indicates the compartment in which the item is located (how far back). The LED bar is an efficient picking tool that has no moving parts and is suitable for use with load trays that have compartments 200 mm in size and above. This is a cost-effective option for larger compartments, where light pointers do not give the best guidance,. The LED bar requires the use of a pick display that indicates items in or items out, preventing picking errors.

Light pointer

Light pointers shine a solid green light on the location on the load tray from which the item is to be picked. It requires the use of a pick display that specifies how many of each item is to be picked at each point of light. For users handling many small items and many compartments on each load tray, a light pointer is a very effective tool.



LED bar





Pick display

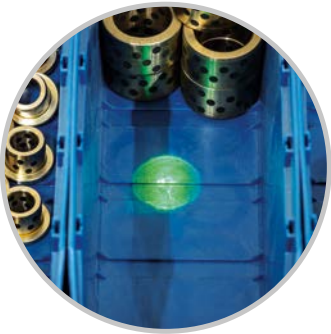

Light pointer

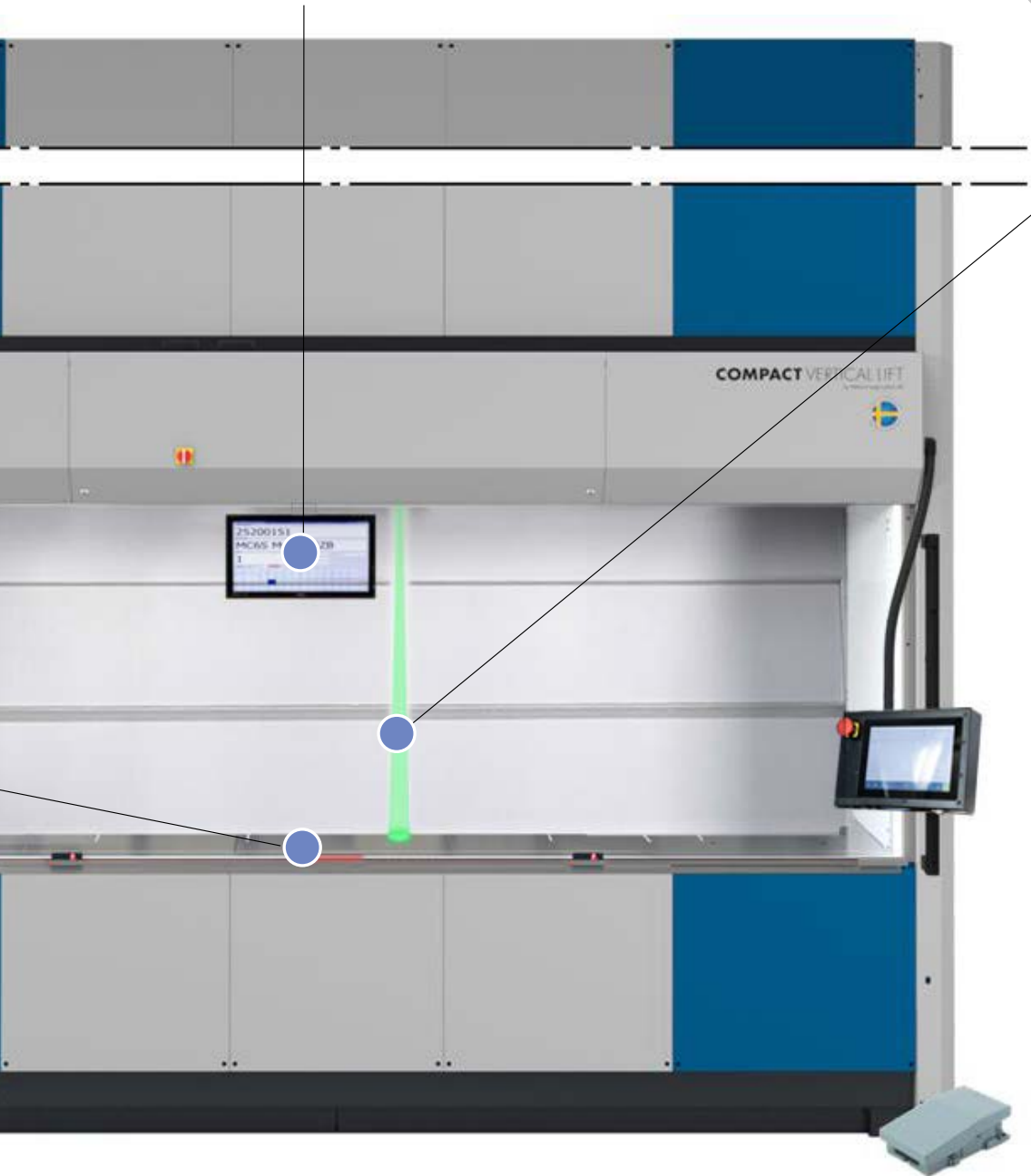

Easy to design custom labels

Everything is integrated in Compact Store



COMPACT VERTICAL LIFT

by Wälchli Systems AG



More information can be found in

- System Setup
- Installation Description
- User Guide
- Trainings

